

# PURE WOOD BLINDS TECHNICAL SPECIFICATIONS



2015 Version 1.2

PURE  
WOOD

BLINDS

The **ShutterShop**

# PURE WOOD BLIND SPECIFICATION

<b>Section 1</b> Features and benefits	1
<b>Section 2</b> Components and accessories	3
<b>Section 3</b> General specification	8



## **PURE Wood Blinds, tailored towards modern and also a more traditional interior.**

The PURE Wood collection has been designed to turn heads and offers the perfect solution to complement and match their equivalent Shuttershop shutters on certain colours.

Shuttershop's PURE Wood blinds are of exceptional build quality and offer a superior solution for any type of window. Designed to suit every requirement, from modern to classic or even a more traditional look, the PURE Wood offers choice after choice, Shuttershop's PURE Wood blinds are made in Paulownia Wood.

# FEATURES AND BENEFITS

PURE  
WOOD

BLINDS

## THE MADE-TO-MEASURE BLIND RANGE FROM SHUTTERSHOP

The PURE Wood is the most comprehensive blind range in the UK offering a multitude of configurations and finishing options. Shuttershop's PURE Wood blinds are of exceptional build quality and give a superior solution for any type of window.

### Features Include:

#### ■ PURE Privacy\*

Unique to the market, the PureWood range has a patent pending system for securing the slat to the cord ensuring:

- No large punched holes in slats reducing light bleed and increasing privacy
- Tightest slat closure on the market for increased black-out
- Punched slats also available

#### ■ PURE Function

- Advanced easy-lock mechanism
- A single headrail can be used with a number of blinds allowing for all cords to be consolidated at either end of the blind
- Ability to cut-out the blind around door or window furniture
- Hold down brackets for face fixing to doors
- Trapezoid bottom rail eliminates rocking and damage to window sill
- Slats are made of a lightweight material with a beautiful grain
- Easy to use, clean and maintain.

#### ■ PURE Choice

- 50mm and 64mm shutter style slat
- 14 paint and 19 stain colours
- 38 plain and decorative tapes
- Steel headrail with a choice of 6 headrails colours
- High quality, matching wooden valence with a choice of 6 different styles
- Choice of 4 toggle designs

#### ■ PURE Class

- Child safety cord consolidator fitted as standard reducing the risk of potential strangulation
- +/- 6mm tolerance on drop
- Window spans of up to 3 meters can be covered in paint finishes
- Tapes, strings and cords consistently placed same distance from end of slat
- Hygienilac wood lacquer kills most species of bacteria for up to 10 years (10% uplift)
- Finished with 10 Coats plus UV protection layer to resist fading

\* Only available on New Privacy Slat not Centre Slat (See Page 3)

# COMPONENTS AND ACCESSORIES

Image 1.

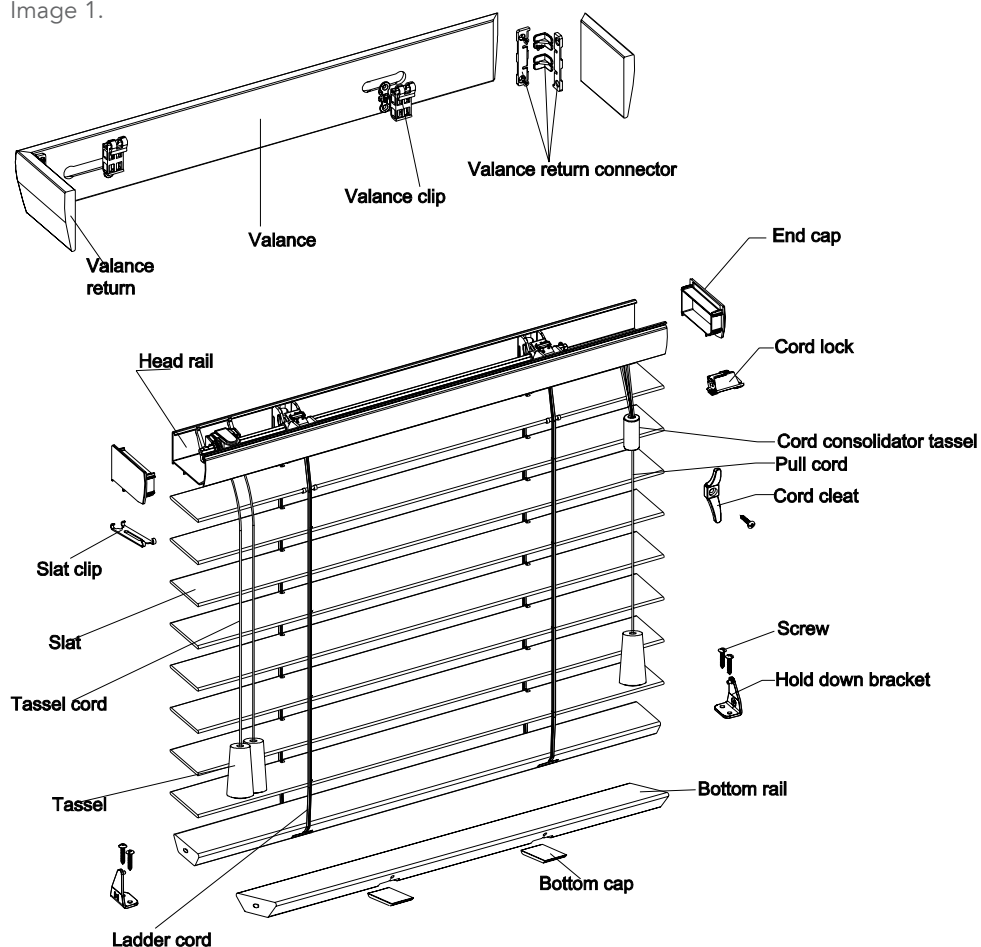

## Valences.

### Standard Valence

Ramp 63.5mm

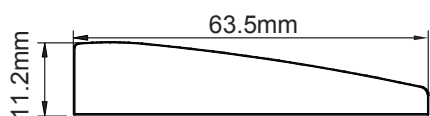

Catenary 63.5mm

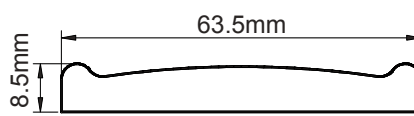

### Optional Valence (surcharge)

Tiara 76.2mm

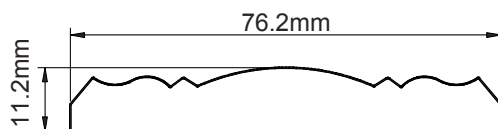

Ramp 76.2mm

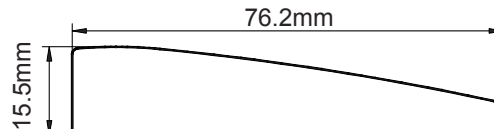

Chamfer 76.2mm

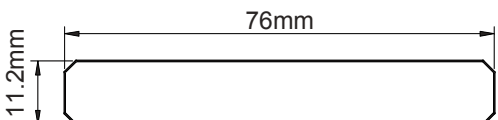

Contempo 89mm

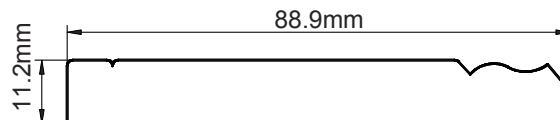

**Headrails.**  
**Standard Headrails**

Steel headrail in 6 colours, colour coordinated with blind colours

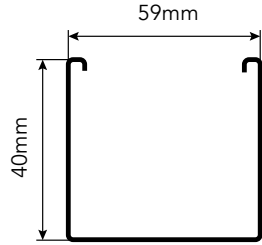

For 50.8mm & 63.5mm slat

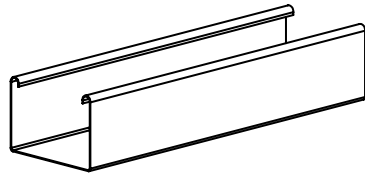

**Bottom rail.**

Incorporate a flush bottom rail cap to minimize gap at the bottom of the blind for recess mount and dent free for window casement.

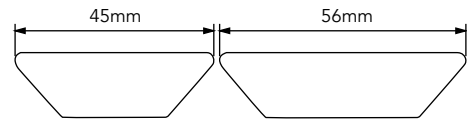

Bottom rail cap:

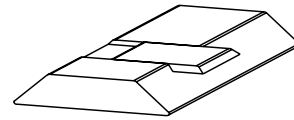

**Slat.**  
 50.8mm & 63.5mm

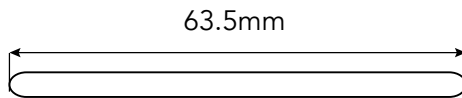
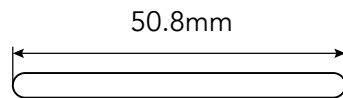

**New Privacy**

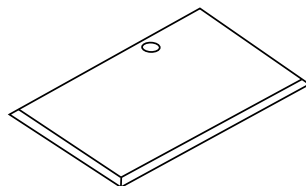

For ladder cord (default)

**Centre Slot**

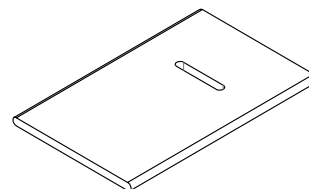

For tape/decorative tape only

**Toggle.**

Made of wood - in the same finish and colour as the blind slats.

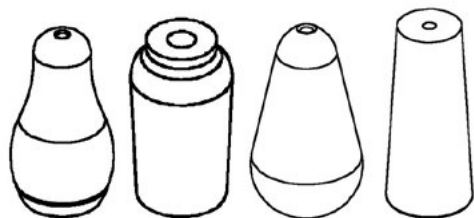

Courbe (37mm) Olive (33mm) Pear (48mm) Taper (48mm)

Please specify the tassel type on order form.

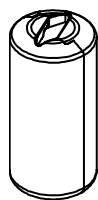
**Cord Consolidator Tassel.**

Safety Tassel  
(38mm)  
Tassel

- Safety tassel is a safeguard for children and is colour coordinated with the slats.

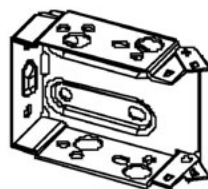
**Installation Brackets.**

For 50.8mm slat  
(Optional for 63.5mm slat)

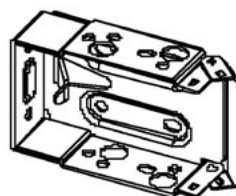

For 63.5mm slat  
(Optional for 50.8mm slat)

**Supporting Brackets.**

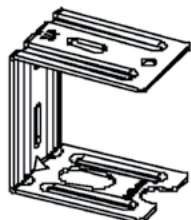

For 50.8mm slat  
(Optional for 63.5mm slat)

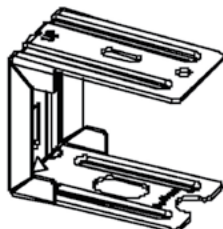

For 63.5mm slat  
(Optional for 50.8mm slat)

**Hold Down Bracket.**

Supplied with each blind.

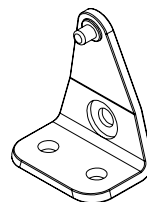

For 50.8mm slat

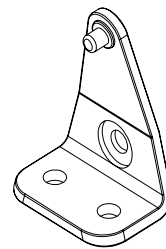

For 63.5mm slat

**Valence installation parts.**

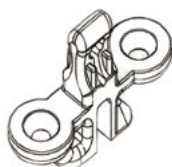

Valence Clip (plug)

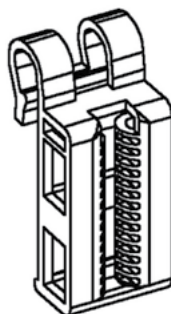

Valence Clip (receptor)

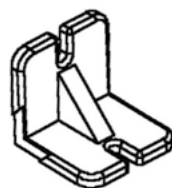

Valence Return Connector

**Valence Connector.**

Supplied for connecting spliced valences.

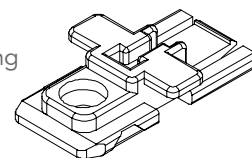

**Optional parts.**

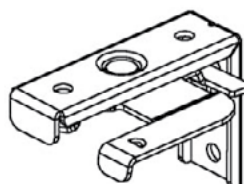

Swivel bracket\* (OM)

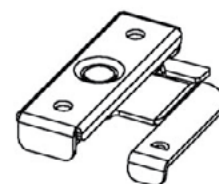

Swivel bracket\* (IM)

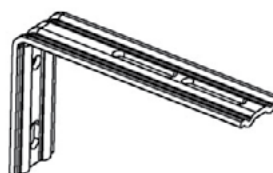

Extension bracket\*\*

**Plastic Cord Cleat.**

Supplied with each blind.

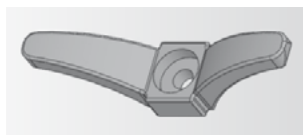

**Please note:**

\* Swivel brackets are optional

\*\* Extension brackets are optional and available upon request, at a surcharge.

# GENERAL SPECIFICATION

## Mounting type and size definition:

	Inside Mount (IM)	Outside Mount (OM)
Mounting Position	Blind fits within window opening	Blind overlaps window opening
Order Size	<b>Window opening size:</b> Provide the smallest measurement from the top, middle and bottom measurement. Top measurement is critical because the headrail must fit. Measure the height left, center and right and provide the biggest height.	<b>Net size:</b> Measure the desired width and height. To minimize light leakage, the blind should overlap the window opening at least 50mm on each side and at the bottom.
Finished Blind Size	Width = Order width - 9.5mm Drop = Order Height	Width = Order Width Drop = Order Height

Finished blind width is equal to slat length; finished blind drop is measured from top edge of headrail to bottom edge of bottom rail with slats in closed position when blind is fully released.

Tolerance on width: ±2mm;  
 Tolerance on drop: 0~6.4mm.

## Size Limit:

### 50.8MM & 63.5MM SLAT:

Blind Type		Width		Height		
		Minimum	Maximum		Minimum	Maximum
			Paint	Stain		
Single Blind		203 mm	3048mm	2438mm	254 mm	3048 mm
Multiple Blinds on one headrail	2-on-1	412 mm			254 mm	3048 mm
	3-on-1	621 mm				



### 50.8mm and 63.5mm – Sizing Chart

The maximum area for PURE Wood single blind (or each section of 2-on-1 or 3-on-1 blind): 7.43m<sup>2</sup>, refer to the following chart for easier calculation.

Width (mm)	2467	2500	2600	2700	2800	2900	3048
Max Drop (mm)	3012	2972	2858	2752	2654	2562	2438

### Bracket Schedule

Blind width	Installation bracket qty	Supporting bracket qty	Swivel bracket qty
$X \leq 927\text{mm}$	2	n/a	2
$927\text{mm} < X \leq 1372\text{mm}$	2	1	3
$1372\text{mm} < X \leq 1981\text{mm}$	2	2	4
$1981\text{mm} < X \leq 2438\text{mm}$	2	3	5
$2438\text{mm} < X \leq 3048\text{mm}$	2	4	6

### Valence and return size.

- No valence return for inside mount - supplied valence will be butt cut.
- Short returns supplied, if returns are required during an inside mount.
- Outside mount blind comes with valence returns, if requested.
- Outside mount valence return length: for 50.8mm & 63.5mm blind, will depend on the installation bracket type, for 50.8mm bracket is 76mm and for 63.5mm bracket is 88mm.

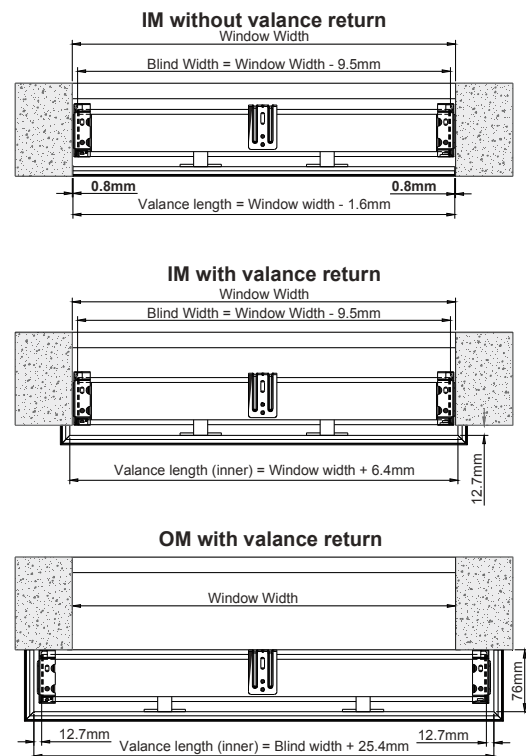

**Control Option.**

Default	Optional
Cord tilt left (L), pull cord right (R)	Cord tilt right (R), pull cord left (L)
	Cord tilt right (R), pull cord right (R)
	Cord tilt left (L), pull cord left (L)
	Centre tilt only for a small blind with a width between 203 - 305 mm

Tilter will be at the outer end when both controls are at the same side. Blinds with width between 305mm and 457mm must have split control, one on left and one on right.

When the width is between 203 and 305 there will be no lock lift mechanism. There will only be a tilt mechanism at the centre of the headrail.

**Ladder Cord schedule.**

Blind Width	Ladder Cords		Blind Width	Ladder Cords	
	Privacy	Centre Slot		Privacy	Centre Slot
	50.8mm Slat			63.5mm Slat	
$165\text{mm} \leq W \leq 305\text{mm}$	2	2	$165\text{mm} \leq W \leq 305\text{mm}$	2	2
$305\text{mm} \leq W \leq 432\text{mm}$	2	2	$305\text{mm} \leq W \leq 432\text{mm}$	2	2
$432\text{mm} < W \leq 813\text{mm}$	2	2	$432\text{mm} < W \leq 927\text{mm}$	2	2
$813\text{mm} < W \leq 1372\text{mm}$	3	3	$927\text{mm} < W \leq 1372\text{mm}$	3	3
$1372\text{mm} < W \leq 1981\text{mm}$	4	4	$1372\text{mm} < W \leq 1905\text{mm}$	4	4
$1981\text{mm} < W \leq 2438\text{mm}$	5	5	$1905\text{mm} < W \leq 2438\text{mm}$	5	5
$2438\text{mm} < W \leq 3048\text{mm}$	6	6	$2435\text{mm} < W \leq 3048\text{mm}$	6	6

**Multiple blinds on one headrail. (surcharge)**

2 on 1 headrail

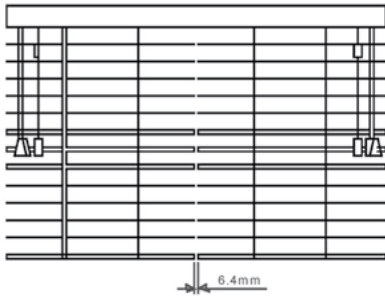

3 on 1 headrail

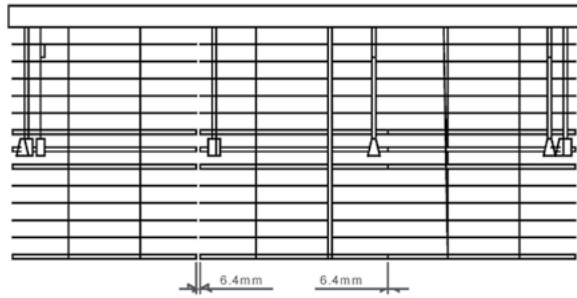

- Alignment of slats is not guaranteed for multiple blinds on one headrail.

**Common Valence.**

- If you require one valence to cover side by side blinds, please use special instructions on the order card to advise us of valence length required.
- Common valence is used for side by side blinds sharing one valence.
- Alignment of slats is not guaranteed for the side by side blinds.
- Valence will be spliced if length exceeds 3100mm in paint and 2500mm in stain. We will supply valence connector for joining.
- Minimum gap size between two blinds is 8mm

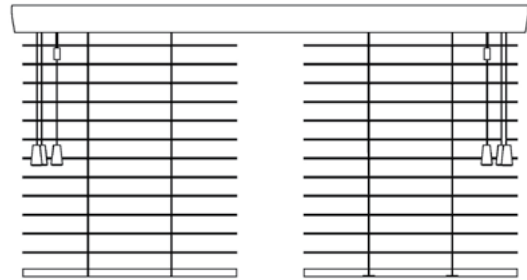

**Groove for Valence.**

- For the common valence or custom valence size, the valence will be made with groove as per the adjacent drawing.
- If the common valence or custom valence size exceeds the limit and needs to be split, the valence will be made with groove as per the adjacent drawing.

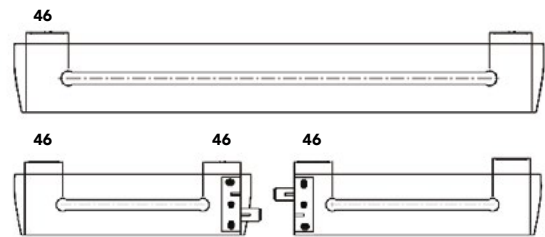

46

**Cut-outs. (surcharge)**

A cut-out is a blind with an area removed from it to avoid an existing obstruction.

Please provide detailed measurement of the area to be removed. Mark your measurements on a template of the cut-out to ensure a perfect fit to your window.

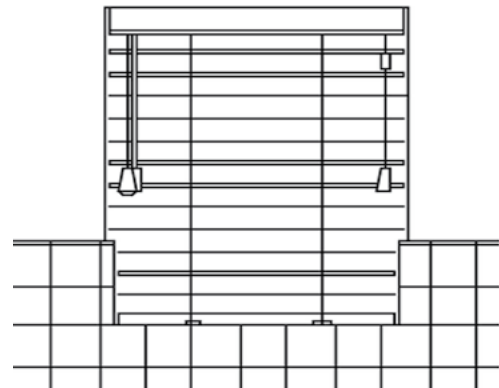

46

**PURE Wood:** 33 Colours, 14 paint & 19 stain (1 chargeable colour)

### 14 paint colours

All paint colours have the grain infilled to give a smooth clean finish

Blind Colour	Ladder/Pull Cord	Safety Tassel	Steel Headrail
001 Pure White	T001 White	2037 Snow White	3058 Pure White
002 Extra White			
003 Silk White			
004 Bright White			
006 Pearl	5020 Alabaster	2012 Cameo	H002 Vanilla
008 Marshmallow			
009 Creamy			
011 Cameo			
012 Crisp Linen			
013 Bisque			
048 Chai	5526 Cottage Pine	P201 Wheat	3523 Sugar Maple
049 Stone Grey	T168 Grey	P101 Grey	3105 Grey
051 Brown Grey			
053 Clay	T201 Black	P201 Black	

### 19 Stained colours

All stained colours do not have the grain infilled to showcase the woods natural beauty

Blind Colour	Ladder/Pull Cord	Safety Tassel	Steel Headrail
108 Rustic Grey	T168 Grey	P101 Grey	3105 Grey
109 Weathered Teak		P402 Light Cocoa	
110 Limed White	5020 Alabaster	2012 Cameo	3058 Pure White
114 Taupe			H002 Vanilla
204 Oak Mantel	5526 Cottage Pine	2522 Teak	3523 Sugar Maple
205 Goldenrod			
211 Cherry	5413 Walnut	P401 Cherry	3436 Coffee
212 Dark Teak		2413 Walnut	
215 Cordovan		P401 Cherry	
219 Mahogany	5430 Mahogany	2437 Mahogany	
220 New Ebony	T168 Grey	P101 Grey	3105 Grey
221 Black Walnut	T201 Black	T201 Black	3208 Black
227 Red Oak	5526 Cottage Pine	2522 Teak	3523 Sugar Maple
229 Rich Walnut	5413 Walnut	2413 Walnut	3436 Coffee
230 Old Teak			
233 Dark Mahogany	5430 Mahogany	2437 Mahogany	3436 Coffee
237 Wenge			
862 French Oak	5526 Cottage Pine	P501 Wheat	3523 Sugar Maple
246 Matte Black*	T201 Black	P201 Black	3208 Black

\* 246 Matte Black incurs surcharge.

**Ladder tape colours:** Face width 25.4mm. Available only with notch out slat

T001 White	T302 Bordeaux	T501 Wheat
T002 Ivory	T303 Dark Mulberry	T601 Cumin
T003 Bone	T401 Cherry	T701 Sea Foam
T169 Grey Beige	T402 Light Cocoa	T702 Navy Blue
T201 Black	T403 Ecu	5462 Black Brown
5434 Dark Sienna	5414 Brown	5124 Dusty Grey
5507 Natual	5416 Chocolate	

**Decorative tape options:** Face width 25.4mm. Available only with notch out slat

T101 Chartreuse Sisley	T102 Amethyst Sisley	T103 Sky Blue Sisley
T104 Mediterranean Sisley	T105 Angora Oxford	T106 Lily Pad Oxford
T107 Auburn Briques	T108 Cream Foliage	T109 Toffee Foliage
T110 Petal Pink	T111 Mosaic	T112 Zebra
T113 Harvest	T114 Garden	T115 Egyptian
T116 Olive Aztec	T117 Ochre Aztec	T118 Ebony Aztec

Decorative cloth tapes are attached to both front and back of tape ladder and are only available with centre slot.

- Colour 110 is finished with a limed lacquer which will feature differences in the colour and grain pattern found in the natural wood.
- Colour 224 is finished with a semi-transparent coating which will feature differences in the colour and grain pattern found in the natural wood.

# STACKING HEIGHTS

CUSTOM BLINDS STACK SIZE (MM)						
Blinds Height	50.8mm Slat			63.5mm Slat		
	mm	LC	CT	DT	LC	CT
250	99	100.4	102.3	108	109	110.4
300	103	105	107.4	111.9	113.3	115.1
350	107	109.5	112.5	115.9	117.7	119.9
400	110	114	117.6	119.9	122	124.6
450	114	118.6	122.7	123.8	126.3	129.4
500	118	123.1	127.8	127.8	130.6	134.1
550	122	127.7	133	131.8	134.9	138.8
600	126	132.2	138.1	135.7	139.2	143.6
650	130	136.8	143.2	139.7	143.5	148.3
700	134	141.3	148.3	143.7	147.8	153.1
750	138	145.9	153.4	147.6	152.1	157.8
800	142	150.4	158.5	151.6	156.4	162.5
850	146	155	163.6	155.6	160.8	167.3
900	150	159.5	168.8	159.5	165.1	172
950	154	164	173.9	163.5	169.4	176.8
1000	158	168.6	179	167.5	173.7	181.5
1050	162	173.1	184.1	171.5	178	186.3
1100	166	177.7	189.2	175.4	182.3	191
1150	170	182.2	194.3	179.4	186.6	195.7
1200	174	186.8	199.4	183.4	190.9	200.5
1250	178	191.3	204.5	187.3	195.2	205.2
1300	182	195.9	209.7	191.3	199.6	210
1350	186	200.4	214.8	195.3	203.9	214.7
1400	190	205	219.9	199.2	208.2	219.4
1450	194	209.5	225	203.2	212.5	224.2
1500	198	214	230.1	207.2	216.8	228.9
1550	202	218.6	235.2	211.1	221.1	233.7
1600	206	223.1	240.3	215.1	225.4	238.4
1650	210	227.7	245.5	219.1	229.7	243.1
1700	214	232.2	250.6	223	234	247.9
1750	218	236.8	255.7	227	238.3	252.6
1800	222	241.3	260.8	231	242.7	257.4
1850	226	245.9	265.9	234.9	247	262.1
1900	230	250.4	271	238.9	251.3	266.9
1950	234	255	276.1	242.9	255.6	271.6
2000	238	259.5	281.3	246.8	259.9	276.3
2050	242	264	286.4	250.8	264.2	281.1
2100	246	268.6	291.5	254.8	268.5	285.8
2150	250	273.1	296.6	258.8	272.8	290.6
2200	254	277.7	301.7	262.7	277.1	295.3

Continued...

# STACKING HEIGHTS

CUSTOM BLINDS STACK SIZE (MM)						
Blinds Height	50.8mm Slat			63.5mm Slat		
	mm	LC	CT	DT	LC	CT
2250	258	282.2	306.8	266.7	281.4	300
2300	262	286.8	311.9	270.7	285.8	304.8
2350	266	291.3	317	274.6	290.1	309.5
2400	270	295.9	322.2	278.6	294.4	314.3
2450	274	300.4	327.3	282.6	298.7	319
2500	278	305	332.4	286.5	303	323.8
2550	282	309.5	337.5	290.5	307.3	328.5
2600	285	314	342.6	294.5	311.6	333.2
2650	289	318.6	347.7	298.4	315.9	338
2700	293	323.1	352.8	302.4	320.2	342.7
2750	297	327.7	358	306.4	324.6	347.5
2800	301	332.2	363.1	310.3	328.9	352.2
2850	305	336.8	368.2	314.3	333.2	356.9
2900	309	341.3	373.3	318.3	337.5	361.7
2950	313	345.9	378.4	322.2	341.8	366.4
3000	317	350.4	383.5	326.2	346.1	371.2
3050	321	355	388.6	330.2	350.4	375.9

---

**Warranty:**

The colour fastness of Custom Blinds is warranted for 3 years.

The structure of Custom Blinds is warranted for 3 years.

The hardware of Custom Blinds is warranted for 1 year.